

JATY Bluetooth (JBHW-0310C)

Saturday, March 15, 2008  
23:13 PM

**JBHW-0310C  
Hands Free Kit For  
Bluetooth Phone**

**Installation and  
User Guide**

*(Please read this manual before installing and using)*



Before install this Handsfree Kit in your vehicle, please read this manual for your reference in the future.

## Features

This Handsfree Kit enables you to use your phone wirelessly in the vehicle.

- Automatically connects to your mobile phone when you are powered and within range (10m) using Bluetooth technology.
- Send and receive calls without picking up the phone.
- Talk on the phone without any restrictions allowing you to drive safely.
- Radio Mute turns your radio off on receiving a call.
- Can be installed with constant power as well as separate ignition acc sensor power.
- Full Duplex.
- 12-24 Volts for use in all vehicles including passenger cars, trucks and buses.

## Table of Contents

In the box .....	5
Installation .....	6
Handsfree Kit connection diagram .....	6
Control unit .....	7
Handsfree speaker .....	8
Handsfree microphone .....	9
Connecting the power supply cable .....	10
Charging Cable(Optional) .....	11
User Guide .....	12
How to use the Bluetooth SPP Handfree kit .....	12
(JBHW-G508)	
1. HFP(Handsfree kit) .....	13
Part Number .....	17

## In the box

When you buy this Handsfree Kit, please check that all components are in the box.

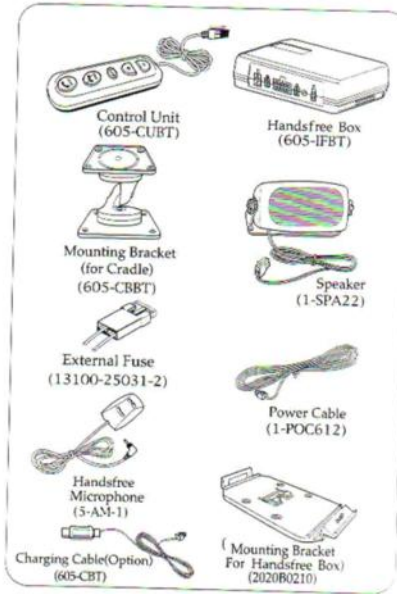

Please read this manual before installing this Handsfree Kit in your vehicle.  
Please pass User Guide onto the Customer.

## Installation

- Select a suitable place to install the Handfree Kit to avoid disturbance while in use.
- When you install the microphone, please select a place least affected by external noise (wind, radio and etc.) Above and in front of the head is best.
- You can use a 12V~24V battery.
- Avoid high temperature and extreme vibration.
- Before installing, check that lengths of cables are ok for the required positions of devices.

### Handsfree Kit connection diagram

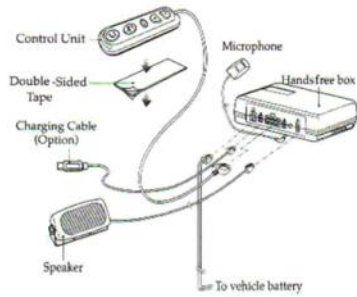

◀ 6 ▶

### Control Unit

1. Choose a suitable mounting location position for easy access while driving.
2. Attach the control unit with the provided double-sided tape.

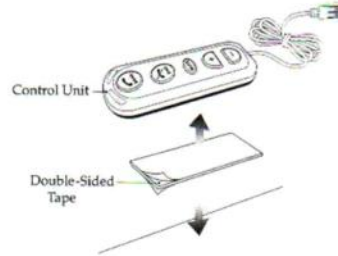

◀ 7 ▶

### Handsfree speaker

1. Connect the speaker's connector plug to the speaker terminal on the Handsfree box.
2. Select proper mounting location for the speaker.

Note : Speaker is generally installed on the side of the passenger's seat.

3. Drill the pilot holes using a drill bit, and install the mounting bracket by using the screws supplied. Screw properly to prevent vibration while driving.

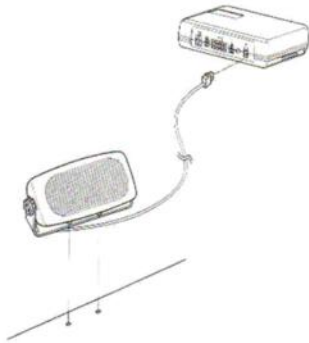

◀ 8 ▶

### Handsfree microphone

1. Connect the microphone's connector jack to the 'MIC' terminal on the Handsfree box.
2. Install the microphone at the proper location.

- The Handsfree microphone should be installed within 30 ~ 45cm proximity of the driver's normal speaking location. For optimum performance, attach the microphone to the near of the driver's sunvisor or appropriate place.

- Care should be taken to position the microphone in a location which will be least susceptible to interference caused by external noise sources, for example, adjacent windows, radio speakers and etc.

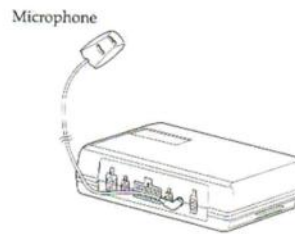

◀ 9 ▶

## Connecting the power supply cable

1. There are four loose wires that can be connected to the car for the proper Handsfree Kit operation. When connecting the wires from the cable harness, be sure to avoid any sharp edges or moving parts.

Note: Connect the red and yellow wires to the supplied fuses, Then connect the short wires from the other side of the fuse, to the battery.

- The red wire must be connected to the vehicle battery. Depending on how your vehicle is equipped, an auxiliary power connection may be found under the dash or near the fuse box. In newer vehicles there may be a fuse box location for a cellular phone. Consult your vehicle owners manual. The red wire must have the external fuse supplied.
- Be sure to use a 250V/3A fuse.
- The black wire must be connected to the vehicle ground(GND) . Attach to the vehicles chassis.
- The yellow wire is the ignition acc on sensor. wire must be connected to the switched side of the ignition switch.
- The white wire is the stereo mute. (Optional use)  
- Connecting method: Connect this wire to the stereo mute wire from your vehicle stereo.  
(check your vehicle stereo owner 's manual, or if the stereo is factory installed, check the vehicle owner' s manual).

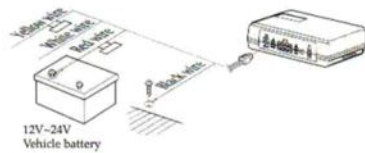

◀ 10 ▶

## Charging Cable(Optional)

1. Connect the Charging Cable's connector jack to the 'CHG' terminal on the Handsfree box.
2. You can charge the phone with Charging Cable.



◀ 11 ▶

## User Guide

### How to use the Bluetooth Handsfree Kit (JBHW-G508)

- Some functions below cannot be used on the some phones which has Headset profile.
- These instructions may differ from your phone.

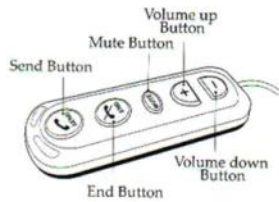

#### \*What is Pairing?

- Pairing is the process of establishing device addresses and connection parameters for the devices so that they automatically connect when required. Pairing need only be done once for each device.
- So, before you use Bluetooth Car Kit, you must link it to your phone. Once the Car Kit and phone are paired, the Car Kit will automatically connect to your phone every time you start your vehicle or power.

#### 1. HFP (Handsfree Kit)

1. Pairing and Connect the phone.
  - Before you use Handsfree Kit, you must link it to your phone.
  - 1) Please press send and end button together for 3 seconds to go to pairing mode and than, the pairing mode keep 60 seconds.
  - 2) Start pairing with your phone (refer to your phones manual or the example below)
  - 3) Password for the pairing is "0000"

#### Example)

Note: These instructions may differ from your phone but will be the same process

- (1) Put the Handsfree kit into Pairing mode as in section above.
- (2) In your phone's Menu find Bluetooth and turn On.
- (3) Search for a New Paired device.
- (4) Select "JBHW-G508" and enter password "0000".
- (5) Next select options for "JBHW-G508" and select Connect (Required for some phones only)

#### 2. Making and Ending a Call

- 1) Dial a number on your phone and press the Send Button on your phone.
  - 2) Press the End Button on the Control Unit to hang up a call.
- Redial
    - Press the Send Button on the Control Unit once, Car Kit will dial your last called number.

### 3. Receiving and Rejecting a Call

- 1) Press the Send Button on the Control Unit to answer an incoming call.
- 2) Press the End Button on the Control Unit to reject an incoming call.

### 4. Voice Dial

(Record voice commands in your phone first according to your phones manual)

- 1) Press and hold the Send Button on the Control Unit for 1.5 seconds.
  - 2) Say the voice command of the contact you want to call.
- Note : If you try to Voice Dial when the phone is not connected to the Handsfree Kit, Handsfree Kit will automatically connect to the last connected phone and go to the Voice Dial Mode.

### 5. Transferring a Call

- 1) From the Car Kit to the phone
    - During a call, press Send button on the Control Unit.
  - 2) From the phone to the Car Kit
    - During a call, press the Send button on the control unit.
- \* Some of phones will disconnected when you try to transfer a call.

### 6. Speaker Volume

- 1) Press the Volume Up key to increase the Speaker Volume.
  - 2) Press the Volume Down key to decrease the Speaker Volume.
- \* There are 8 Volume levels. When you increase the volume level, you will hear a beep sound twice at level 8.
  - \* Phone volume level will be also increased and decreased when you up, down the volume on the Control Unit.

### 7. Microphone Mute

- 1) Press the Mute button once to turn the microphone off.
  - 2) Press again to turn the microphone back on.
- \* When you microphone off, you will hear a beep sound for every 4 seconds.

### 8. Microphone Volume

- 1) Press Mute button and Volume Up button to increase the microphone volume.
- 2) Press Mute button and Volume Down button to decrease the microphone volume.

### 9. Auto Connection

- 1) When you turn on the Car Kit, Car kit will search for the last 3 devices. It takes 6 second for each devices.
- 2) If auto connection fail, there will be a short beep sound.
- 3) If there's no paired information stored, Handsfree Kit will go to the Paring Mode.
- 4) If you press End button for 4 second, you call disconnect the phone from the Handsfree Kit.

Note: Some phone needs authorize for the auto connection.

10. Deleting Paired Devices

If your kit will not connect or if you pair using the wrong mode, try deleting all stored paired information and then Re-Pair your devices.

- 1) Press and hold Volume Up(+) and Volume down(-) button for 5 seconds.

Note: You can pair the JBHW-G508 With up to 8 different phones.  
ie... The JBHW-G508 can store connection information for 8 devices, but can connect with only one phone at a time.

11. Call Waiting

- Call waiting is a feature that provides a beep to alert another call is waiting. Allows the waiting call to be answered without disconnecting from the existing call.

- 1) Press Send button for 1.5 second.
- 2) The first call is put on hold and you are connected to the second call.
- 3) To return to the original call, press the Send button for 1.5 second again.
- 4) You can switch back and forth between two calls.

**Part Number**

Control Unit .....	605-CUBT
Handfree Box .....	605-IFBT
Mounting Bracket (for-Cradle) .....	605-CBBT
Mounting Bracket (for-Handfree Box) .....	2020B0210
Handsfree Microphone .....	5-AM-1
Power Cable .....	1-POC612
Speaker .....	1-SPA22
External Fuse .....	13100-25031-2
Charging Cable(Optional) .....	605-CBT

**MEMO**

A large, empty rectangular box with rounded corners, intended for writing a memo. The box is outlined in black and occupies the upper left portion of the page.